

GMVB 2016

**Saturday
August 6, 2016
8:00 am - ?**



Trophies - 1st place team members will each receive individual trophies.

SILENT AUCTION

A Silent Auction featuring various valuable items will be held throughout the day with the current high bids posted. The highest bidder at the end of the auction will take home the item. Bring along some extra cash.

100% of the funds raised from the Silent Auction will go to the Evangelical Children's Home of St. Louis and other local charities.

If you know anyone who might give something for the Silent Auction, please help us!
(Call Jon at 314-604-7750) We appreciate any assistance we can get.

◆ MVB Rules ◆

Entry fee must be paid in advance

Fee is \$120 if paid by July 11th. \$140 if paid after July 11th.

***** NO POSITIONS HELD WITHOUT PAYMENT *****

Tournament begins at 8:00 am. You will be notified of the starting time of your first game by Thursday evening Aug. 1. Please make sure we have a number or email where you can be reached.

Double elimination tournament

Co-ed rosters of 6-10 players

Must play 6 players on the court (at least 3 of which must be female)

Liberal substitutions after any point

Rally Points - Games are played to 21 points—Team must win by 2 points or 1st team to reach 23

Referees decisions are final

ALL PLAYERS MUST REPORT TO HOSING OFF AREA BEFORE ENTERING POOL AREA OR TEAM WILL BE DISQUALIFIED

WE RESERVE THE RIGHT TO REFUSE SERVICE TO ANYONE CREATING A DISTURBANCE OR WHO WE BELIEVE HAS HAD TOO MUCH TO DRINK * MUST BE 21+ TO PURCHASE ALCOHOL * WE ARE NOT RESPONSIBLE FOR ACCIDENTS OR INJURIES SUFFERED ON THE PREMISES. PLAY AT YOUR OWN RISK * NO LIFEGUARD ON DUTY

Children must be accompanied at all times while in the pool area.

Limited Parking - PLEASE CARPOOL
NO COOLERS - NO PETS

Early Pig Package
See other side for details

GMVB 2016 Official Registration

Registration is not complete until the roster is filled out completely and returned with fee. You will be contacted when your entry is received. Please be sure and have a number or email address where someone can be reached on the Thursday or Friday prior to the tournament.

Team Name _____
Team Captain _____
Address _____
City _____ St _____ Zip _____
Phone _____
Email _____

**Paid by Jul 11 \$120
Pd After Jul 11 \$140
Early Pig Pkg \$199 *
(Only until Jul 11)**

Shirt Sizes	Amount Paid
<input type="checkbox"/>	\$
<input type="checkbox"/>	
<input type="checkbox"/>	
<input type="checkbox"/>	

Sizes available: S-XX

Send checks & registration to:
Jan Schoendienst
313 Estate Drive
O'Fallon MO 63366
(636) 379-1546
**Please make checks payable to:
R.A.A.C.
(Redman Acres Athletic Club)**

Early Pig Package

You Get	Value
Entry Fee	120
6 GMVB T-Shirts	90
6 Drink Huggers	12
Raffle Tickets	20
Total Value	\$242

ONLY \$199

Must Purchase by July 11

More info at <http://GluttonsESS.com/GMVB>



Map to Glutton Club

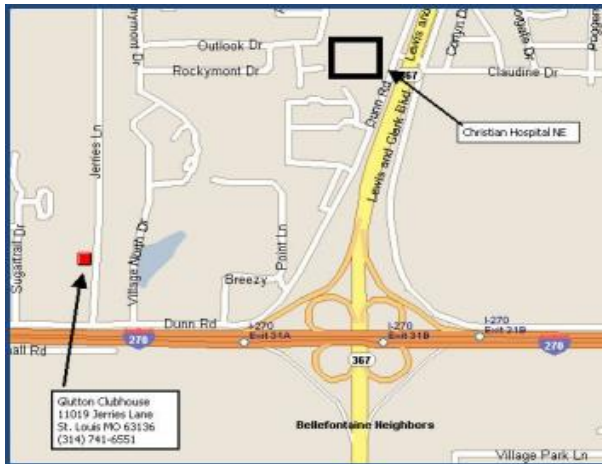

We Accept

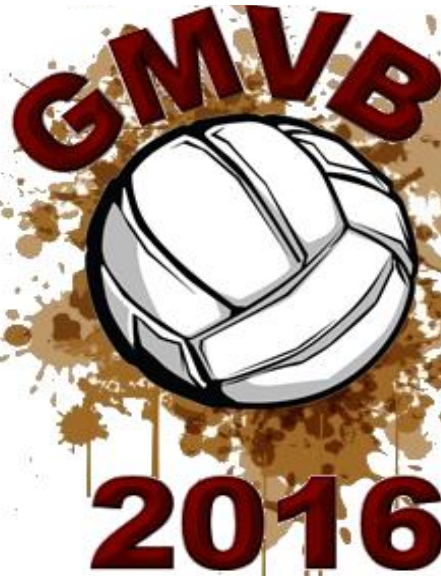

ONLINE REGISTRATION

You can now
register for **GMVB**
2016
online at

<https://squareup.com/market/GluttonsClub>

Link can be found on the Glutton website
www.GluttonsESS.com

The Gluttons
Redman Acres Athletic Club
11019 Jerries Lane
St. Louis MO 63136



ONLINE REGISTRATION

Glutton
Mud Volleyball
Tournament
Saturday
August 6, 2016
8:00 am - ?

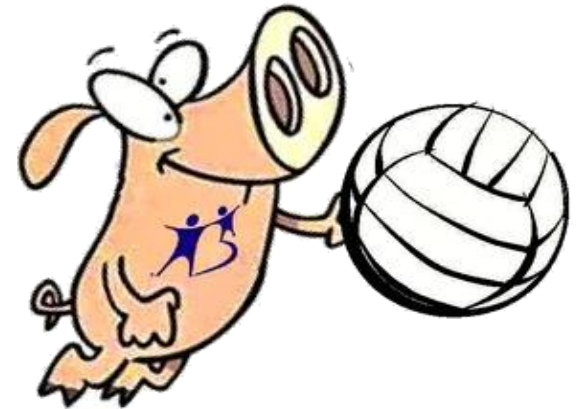

SILENT AUCTION

100% of Auction proceeds go to
Evangelical Children's Home and
other local charities.



This event
will be held
rain or shine.

