

GMVB 2013

**Saturday
August 3, 2013
8:00 am - ?**



Trophies - 1st place team members will each receive individual trophies.

SILENT AUCTION

A Silent Auction featuring various valuable items will be held throughout the day with the current high bids posted. The highest bidder at the end of the auction will take home the item. Bring along some extra cash.

100% of the funds raised from the Silent Auction will go to the Evangelical Children's Home of St. Louis and other local charities.

If you know anyone who might give something for the Silent Auction, please help us!
(Call Jon at 314-604-7750) We appreciate any assistance we can get.

◆ MVB Rules ◆

Entry fee must be paid in advance

Fee is \$120 if paid by July 15th. \$140 if paid after July 15th.

*** **NO POSITIONS HELD WITHOUT PAYMENT** ***

Tournament begins at 8:00 am. You will be notified of the starting time of your first game by Thursday evening Aug. 1. Please make sure we have a number or email where you can be reached.

Double elimination tournament

Co-ed rosters of 6-10 players

Must play 6 players on the court (at least 3 of which must be female)

Liberal substitutions after any point

Rally Points - Games are played to 21 points—Team must win by 2 points or 1st team to reach 23

Referees decisions are final

**ALL PLAYERS MUST REPORT TO HOSING OFF AREA BEFORE ENTERING POOL AREA
OR TEAM WILL BE DISQUALIFIED**

WE RESERVE THE RIGHT TO REFUSE SERVICE TO ANYONE CREATING A DISTURBANCE OR WHO WE BELIEVE HAS HAD TOO MUCH TO DRINK * MUST BE 21+ TO PURCHASE ALCOHOL *

WE ARE NOT RESPONSIBLE FOR ACCIDENTS OR INJURIES SUFFERED ON THE PREMISES.

PLAY AT YOUR OWN RISK * NO LIFEGUARD ON DUTY

Children must be accompanied at all times while in the pool area.

Limited Parking - PLEASE CARPOOL

NO COOLERS - NO PETS

Early Pig Package

See other side for details

GMVB 2013 Official Registration

Registration is not complete until the roster is filled out completely and returned with fee. You will be contacted when your entry is received. Please be sure and have a number or email address where someone can be reached on the Thursday or Friday prior to the tournament.

Paid by Jul 15 \$120

Pd After Jul 15 \$140

Early Pig Pkg \$199 *

*** (Only till Jul 15)**

Send checks & registration to:

Jan Schoendienst

313 Estate Drive

O'Fallon MO 63366

(636) 379-1546

**Please make checks payable to:
R.A.A.C.**

(Redman Acres Athletic Club)

Shirt Sizes	

Sizes available: S-XX

Amount Paid \$

Team Name _____

Team Captain _____

Address _____

City _____ St _____ Zip _____

Phone _____

Email _____

Early Pig Package

You Get	Value
Entry Fee	120
6 GMVB T-Shirts	90
Food & Drink	20
Raffle Tickets	20
Total Value →	\$250

STILL ONLY \$199

Must Purchase by July 15

More info at <http://GluttonsESS.com/GMVB>



Map to Glutton Club

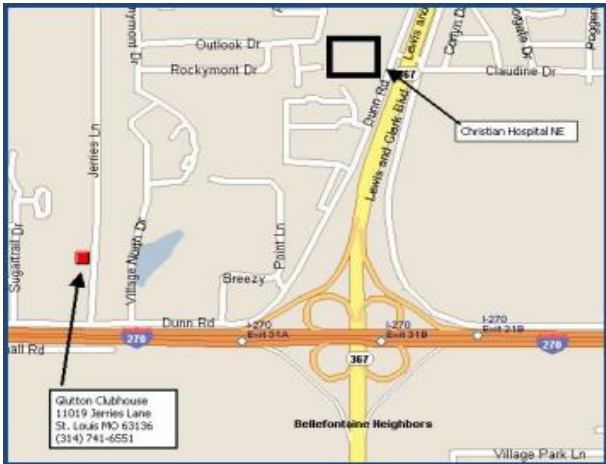

We Accept



Glutton Mud Volleyball - Saturday, August 3, 2013

To:

The Gluttons
 Redman Acres Athletic Club
 11019 Jerries Lane
 St. Louis MO 63136

Glutton Mud Volleyball Tournament
Saturday
August 3, 2013
8:00 am - ?



SILENT AUCTION

All Proceeds go to Childrens Home and other local charities.



This event will be held rain or shine.

